

* Say N. 44 1/2 E. 88 P^s

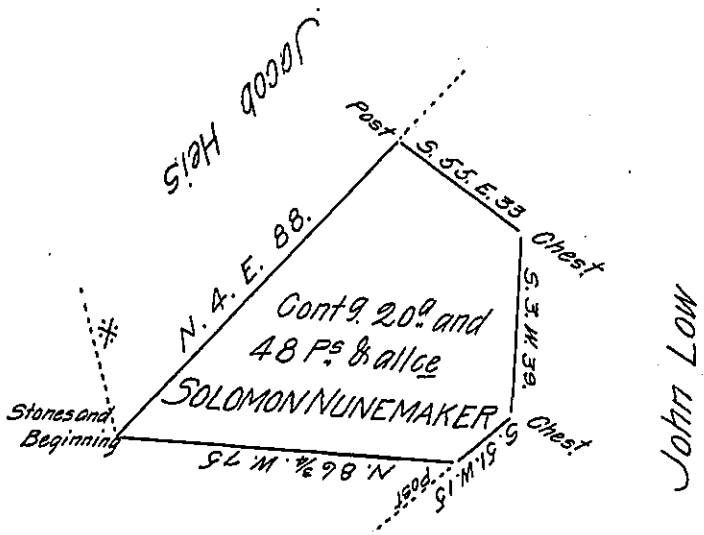

Solomon Nunemaker's other Land

Situate in Shrewsbury Township in the County of York containing as above set forth 20^o & 48 Perches and allowance of Six Per Cent & c. Surveyed on the 29th of the 9^{mo} 1794. by William Kersey late D.S. In pursuance of a Warrant for 19^o Granted to Solomon Nunemaker dated the 10th day of September A.D. 1794. And now at the request of the Said Solomon Nunemaker, we are desired to make return of the draught the 18th day of July A.D. 1808.

Per

To Samuel Cochran Esq^r
 Surveyor General
 Lancaster P^a

Jacob Spangler D.S.

John Eichelberger D.S.

IN TESTIMONY that the above is a copy of the original remaining on file in the Department of Internal Affairs of Pennsylvania, made conformably to an Act of Assembly approved the 16th day of February, 1833, I have hereunto set my Hand and caused the Seal of said Department to be affixed at Harrisburg, this thirtieth day of March 1906.

Joac B Brown
 Secretary of Internal Affairs.